



Standard terminals



Figure	Wire size mm ² (AWG)	Ø Insulation (mm)	Tab thickness (mm)	Part number	Brass	Brass Pre-Sn	Brass Sn	Bronze	Bronze Pre-Sn	Bronze Sn	Steel Ni	Material thickness (mm)	Parts x reel
					00	01	02	30	31	32	24		
	1-2,5 (18-14)	3-4,3	5x0,5	4472.	•		•	•		•		0,4	9.000
			5x0,8	4468.	•		•	•		•			

	1-2,5 (18-14)	3-4,3	5x0,5	4476.	•		•	•		•		0,4	8.000
			5x0,8	4466.	•		•	•		•			



Standard self-locking terminals



Figure	Wire size mm ² (AWG)	Ø Insulation (mm)	Tab thickness (mm)	Part number	Brass	Brass Pre-Sn	Brass Sn	Bronze	Bronze Pre-Sn	Bronze Sn	Steel Ni	Material thickness (mm)	Parts x reel
					00	01	02	30	31	32	24		
	0,5-1,25 (20-16)	1,8-4,1	5,2x0,5	4766.	•		•	•		•		0,35	10.000
			5,2x0,8	4767.	•		•	•		•			

Receptacles for connector

5 (.197) Type series terminals



Standard terminals

Figure	Wire size mm ² (AWG)	Ø Insulation (mm)	Tab thickness (mm)	Part number	Brass	Brass Pre-Sn	Brass Sn	Bronze	Bronze Pre-Sn	Bronze Sn	Steel Ni	Material thickness (mm)	Parts x reel
					00	01	02	30	31	32	24		
	1-2,5 (18-14)	3-4,3	5,2x0,8 (1)	4370.	•		•	•		•		0,4	9.000
(1) Ask for tab thickness of 0,5 mm													



Flags



Standard terminals

Figure	Wire size mm ² (AWG)	Ø Insulation (mm)	Tab thickness (mm)	Part number	Brass	Brass Pre-Sn	Brass Sn	Bronze	Bronze Pre-Sn	Bronze Sn	Steel Ni	Material thickness (mm)	Parts x reel
					00	01	02	30	31	32	24		
	0,5-1,5 (20-16)	2-3,3	5x0,5 5x0,8	5472. 5476.	• •		• •	• •		• •		0,4	3.000



Low insertion

Figure	Wire size mm ² (AWG)	Ø Insulation (mm)	Tab thickness (mm)	Part number	Brass	Brass Pre-Sn	Brass Sn	Bronze	Bronze Pre-Sn	Bronze Sn	Steel Ni	Material thickness (mm)	Parts x reel
					00	01	02	30	31	32	24		
	0,5-1,5 (20-16)	1,9-3,3	5x0,5 5x0,8	5872. 5876.	• •	• •		• •	• •		• •	0,35	5.000 4.500
	1-2,5 (18-14)	2,7-3,8	5x0,5 5x0,8	5874. 5878.	• •	• •		• •	• •		• •		



Flags

5 (.197) Type series terminals



Flag housings

Figure

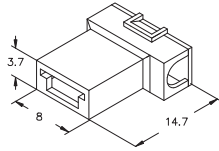

Part number

2483410

Polyethylene	PA66 V2	PA66 V0	NO FLAME
--------------	---------	---------	----------

Colour

Natural

Flags for connector



Standard terminals

Figure

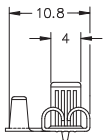

Wire size mm ² (AWG)	Ø Insulation (mm)	Tab thickness (mm)	Part number	Brass 00	Brass Pre-Sn 01	Brass Sn 02	Bronze 30	Bronze Pre-Sn 31	Bronze Sn 32	Steel Ni 24	Material thickness (mm)	Parts x reel
0,5-1,5 (20-16)	2-3,3	5x0,5	5372.	•		•	•		•		0,4	3.000
		5x0,8	5376.	•		•	•		•			

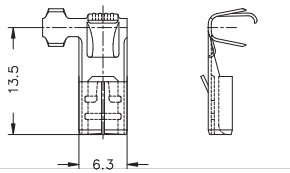

Tabs



Standard terminals

Figure

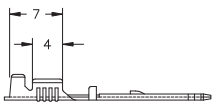

Wire size mm ² (AWG)	Ø Insulation (mm)	Tab thickness (mm)	Part number	Brass 00	Brass Pre-Sn 01	Brass Sn 02	Bronze 30	Bronze Pre-Sn 31	Bronze Sn 32	Steel Ni 24	Material thickness (mm)	Parts x reel
0,5-1 (20-18)	1,5-2,1 FLR	5x0,8	6768.	•	•		•	•			0,4	5.000
			6772.	•	•		•	•				
			6776.	•	•		•	•				
1-3 (18-12)	3-4,3											

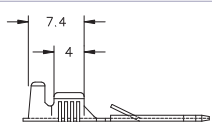
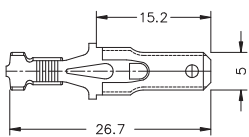

1-2,5 (18-14)	3-4,3	5x0,8	6466.	•	•						0,4	7.000
------------------	-------	-------	-------	---	---	--	--	--	--	--	-----	-------

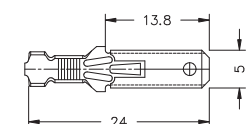

Other special housings

5 (.197) Type series terminals

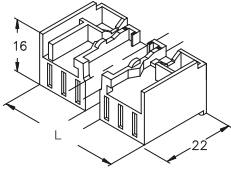
Figure	Part number	Polyethylene	PA66 V2	PA66 V0	NO FLAME	Colour	Num.of ways
	2505210		•			Natural	2
	2505215		•			Black	
	2505310		•			Natural	3
	2505315		•			Black	
	2505410		•			Natural	4
	2505415		•			Black	
	2505510		•			Natural	5
	2505515		•			Black	
	2505610		•			Natural	6
	2505612		•			Yellow	
	2505614		•			Green	
	2505615		•			Black	

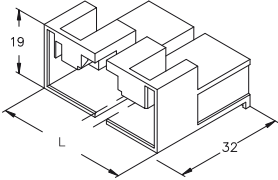
	2504210		•			Natural	2
	2504215		•			Black	
	2504410		•			Natural	4
	2504415		•			Black	
	2504610		•			Natural	6
	2504612		•			Yellow	
	2504614		•			Green	
	2504615		•			Black	

	2507015		•			Black
---	---------	--	---	--	--	-------

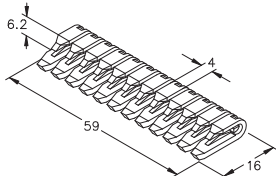
	2507013		•			Red
---	---------	--	---	--	--	-----